

Collect | Hook SC46 Space Copenhagen 2020



Congratulations with your new Collect | Hook, designed in 2020 by Space Copenhagen. We hope you will enjoy using this product and follow these instructions to ensure correct installation. If you have any questions or comments, please do not hesitate to contact us by mail on: info@andtradition.com

Please read these instructions carefully and retain them for future reference to ensure that the product is used correctly. For your own safety, please study each step of this instruction manual first. &tradition is not responsible for any faults or damages caused by not following these instructions correctly.

Safety precautions

- Dispose of plastic bag from packaging and do not allow children to play with it.
- The hook is only intended for indoor use.
- Handle hook with care in order not to scratch surfaces.
- Spilled liquids of any kind should be removed immediately from the hook as it may penetrate the surface treatment and cause damage to it.

Cleaning instructions

- Wipe hook with a soft, damp sponge or cloth, and wipe immediately after with a dry cloth.
- Do not use any abrasive cleaning tools such as steel wool, scouring sponges or stiff brushes.
- Never use strong cleaning agents such as white spirit, turpentine, household glass cleaner or cellulose thinners on the hook.

Content

The package contains the following items:

- A** Collect | Hook
- B** Plugs ×2
- C** Screws ×2

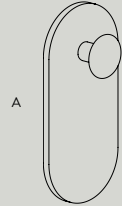

A

Tools needed

- Spirit level
- Pencil
- Electric drill
- Screwdriver

B



C



***Please note that the plugs (B) are only intended for stone and wooden walls, if the product is going to be hung on a different type of wall, please use plugs that are specialized for this.**

Step 1

Using a spirit level, mark the placement of the hook with a pencil.

Make marks with the following distance: 2 marks with a vertical distance of 13 cm.

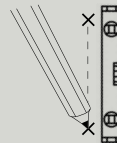

Step 2

Drill holes on the marks and insert plugs.

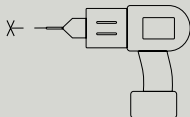

Step 4

Align the holes of the base with the holes in the wall.
Mount the hook by fastening the screws with a screwdriver.

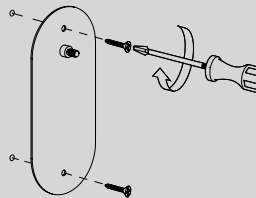

Step 3

Rotate the grip of the hook until it is unattached.
Then, remove the cover.

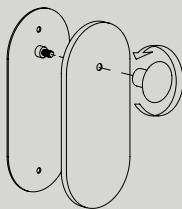

Step 5

Place the cover matching the wall base. Then place
the grip of the hook aligning with the attached
threaded rod and rotate the grip until it is tightly
fasten.

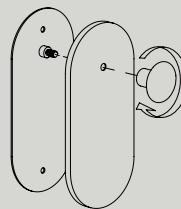

& Tradition®